

# HILTON NEW YORK

## AMERICAS HALL I—Level I

## AMERICAS HALL II—Level II

All exhibit booths are 8' x 10' and include one 6' skirted/draped table, I.D. sign, and waste basket. Both halls are carpeted.

Preferred booths in yellow

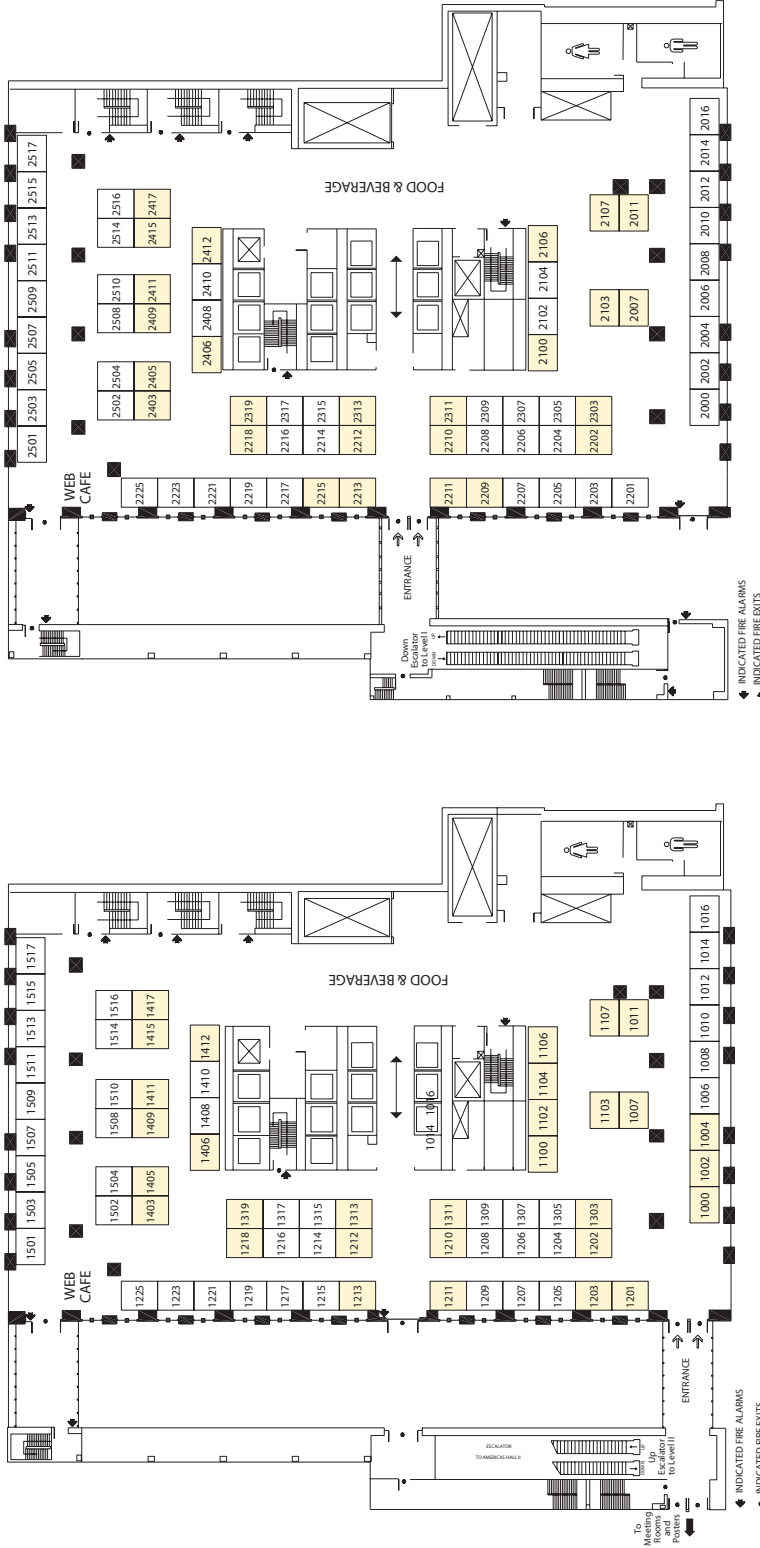

# CONTROLLED RELEASE SOCIETY

JULY 12-16, 2008